

WALTER PIERCE PAVILION



The Walter Pierce Pavilion forms part of the Rockhampton Showgrounds Complex, a diverse, multi purpose site, situated right in the heart of Rockhampton.

This pavilion is a spacious, concrete floored building ideal for medium to large scale events.

LOCATION:

The Rockhampton Showgrounds, Exhibition Road, only minutes from the CBD, airport and the beautiful Fitzroy River precinct.

TYPE OF VENUE:

A spacious authentic style building with kitchen facilities and interior and exterior serving areas.

AREA / FLOORSPACE:

Approx 2130m²

KEY FEATURES:

- Kitchen facilities with inside and outside serving options (available upon negotiation with the lease holder)
- 3.8m graduating to 5m ceiling height
- Wheelchair accessible
- Toilet facilities located nearby
- Easy service access
- On-street and off-street parking nearby
- Power – standard 10 amp and 15 amp outlets available
- Ticketing available

EXTRAS

Sound, lighting and other equipment available for hire through our office

IDEALLY SUITED FOR:

Trade shows, retail sales, auctions, large dinners, functions, conferences and seminars, product launches, wedding receptions, Christmas party functions, school formals.

RATES

Rockhampton Regional Council adopted fees and charges will apply

FLOOR PLAN

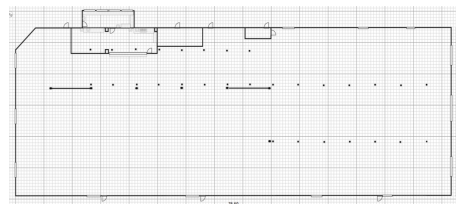

SHOWGROUNDS

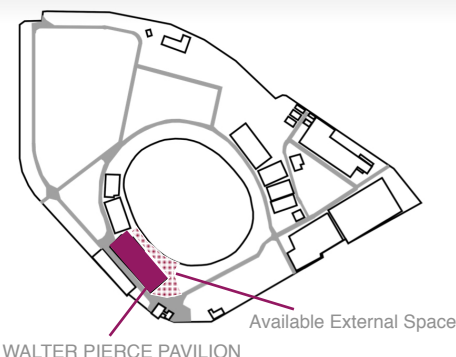

Current as at April 2020

PO Box 1860 Rockhampton Qld 4700 T. 07-49245600

E. majorvenues@rrc.qld.gov.au

Rockhampton Showgrounds is owned and operated by Rockhampton Regional Council.

www.seeitlive.com.au

Rockhampton
Regional Council

WALTER PIERCE PAVILION

